

**Material**

3.0mm galvanised steel, 10mm hole

**Sizes**

325mm to 800mm diameter

**Note**

It is strongly recommended that Hanging Brackets and Bracket Legs be used every second length of duct.

## Hanging Brackets and Bracket Legs

Code HB (Hanging Brackets)

Code WBL (Bracket Legs)

325mm to 800mm

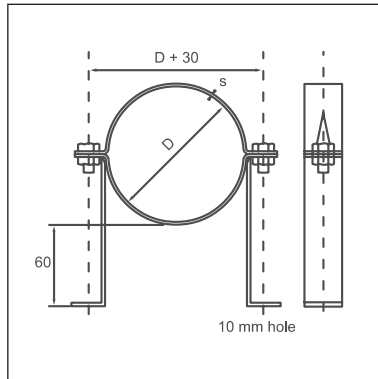

With legs

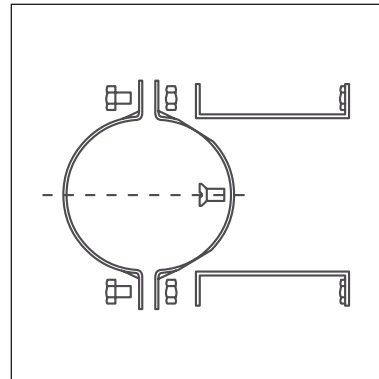

For wall mounting

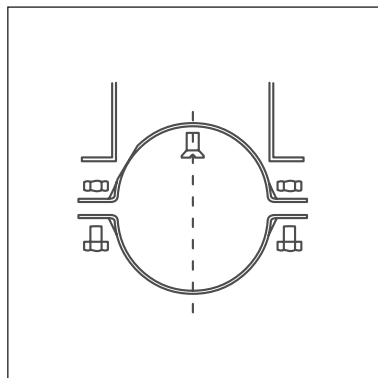

Suspended



Bracket Legs

### Dimensional Specifications

D mm	S mm	Weight kg
325	3,00	1,80
350	3,00	1,95
375	3,00	2,20
400	3,00	2,50
425	3,00	2,65
450	3,00	2,80
500	3,00	3,00
550	3,00	3,35
600	3,00	3,60
630	3,00	3,70
650	3,00	3,85
700	3,00	4,00
750	3,00	4,35
800	3,00	4,80